

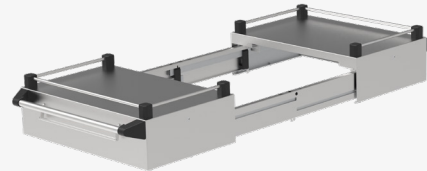

More Info



Data sheet

Sliding cover, pull-out - Norm trolley 2

The ideal extension of the STW 2.

The optional sliding cover is equipped with a 3-sided railing on each end. Ideal for placing GN containers that are secured by the railing. During food service, the two extended ends can be used as an extension of the storage and work surface.

For use with all STW 2 models - not retrofittable.

TECHNICAL SPECIFICATIONS

Sliding cover, pull-out - Norm trolley 2

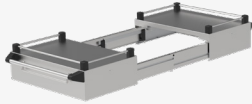

TECHNICAL SPECIFICATIONS

Dimensions 877 x 650 mm

Weight 20 kg

Order number 88 13 20 69

BENEFITS

Expansion of the serving and work area during food service.

The railing secures placed GN containers.

Sturdy and robust.

Cleaning with a suitable detergent for stainless steel, for example with a hot, mild dishwashing solution. Then dry the surface with a soft cloth.